

FOR SALE

\$3,350,000 | 16,074 SF | OFFICE/FLEX

4885 WARD ROAD WHEAT RIDGE, CO 80033



SELLER FINANCING AVAILABLE!

DIGBY
COMMERCIAL ADVISORS
15000 W 44TH AVE. SUITE C GOLDEN, CO 80403
720.843.1330 | WWW.DIGBYCOMMERCIAL.COM

TANNER DIGBY, SIOR
President
O: 720.843.1330 Ext. 104
C: 720.402.7578
Tanner@Digbycommercial.com

LAUREN MOYER
Associate Broker
O: 720.843.1330 Ext. 101
C: 720.960.1995
Lauren@Digbycommercial.com

CONFIDENTIALITY & CONDITIONS

All material and information contained in this marketing material is provided solely for the purpose of considering the purchase of enclosed Property and is not to be used for any other purposes. This information should not, under any circumstances, be photocopied or disclosed to any third party without written consent of Digby Commercial Advisors LLC or Property Owner ("Owner") or used for any purpose whatsoever other than to evaluate the possible purchase of the Property.

Neither Digby Commercial Advisors LLC, its directors, officers, agents, advisors, or affiliates, nor the Owner make any representation or warranty, express or implied, as to the accuracy or completeness of the information contained herein, and nothing contained herein is or shall be relied upon as a promise or representation as to the future performance of the Property. Digby Commercial Advisors LLC and the Owner disclaim any and all liability for representations or warranties, expressed or implied, contained in or omitted from this marketing material, or any other written or oral communication transmitted or made available to the recipient. The recipient shall be entitled to rely solely on those representations and warranties that may be made to it in any final, fully executed, and delivered Real Estate Purchase and Sale Agreement between it and Owner. The information contained herein is subject to change without notice, and the recipient of these materials shall not look to Owner or Digby Commercial Advisors LLC, nor any of their officers, agents, advisors, or affiliates, for the accuracy or completeness thereof. Any party contemplating the purchase of this Property is urged to verify all information, and conduct their own inspections and investigations, and outsource any third-party independent professional if deemed necessary.

The Owner expressly reserves the right, at its sole discretion, to reject any or all expressions of interest to purchase the Property and expressly reserves the right, at its sole discretion, to terminate discussions with any entity at any time with or without notice. The Owner shall have no legal commitment or obligation to any entity reviewing the marketing material or making an offer to purchase the Property unless and until the Owner executes and delivers assigned Real Estate Purchase Agreement on terms acceptable to Owner, in Owner's sole discretion. By submitting a purchase agreement or letter of intent, a prospective purchaser will be deemed to have acknowledged the foregoing and agreed to release Owner and Digby Commercial Advisors LLC from any liability with respect hereto.

PROPERTY INFORMATION

4885 WARD ROAD
WHEAT RIDGE, CO 80033



PRICE	\$3,350,000
NOI	\$242,776
CAP RATE	7.25%
YEAR BUILT	2001
LOT SIZE	66,100 SF (1.512 AC)
BUILDING SIZE	16,074 SF
SUITES	3
TAXES	\$43,121.04
ZONING	C-1 (Wheat Ridge)
PARKING	3.6 1,000
COUNTY	Jefferson
OCCUPANCY	100%

PROPERTY HIGHLIGHTS

- Zoning: **C-1** Wheat Ridge
- Income in place with potential owner-occupancy
- Seller Financing Available
- 1.4 miles from Intermountain Health Lutheran Hospital
- Immediate I-70 access
- **NEW ROOF!**





4885 Ward Road is ideally positioned in the heart of Wheat Ridge, Colorado, offering easy access to both Downtown Denver and the Colorado Front Range. Located minutes from I-70, I-76, and Hwy-58, the property provides seamless connectivity throughout the Denver metropolitan area.

Surrounded by established retail, dining, and service amenities, the location supports convenience for employees and clients alike. The balance of central access and proximity to outdoor recreation makes Wheat Ridge a highly desirable submarket for businesses seeking long-term stability, talent attraction, and quality of life.

With its strategic positioning and amenity-rich surroundings, 4885 Ward Road presents an exceptional opportunity to operate and grow in one of Denver's most accessible and livable markets.

RENT ROLL

4885 WARD ROAD
WHEAT RIDGE, CO 80033

UNIT	SF	TENANT	LEASE COMMENCEMENT	LEASE TERMINATION	BASE LEASE RATE	ESCALATION	RENEWAL
100	4,368	RG and Associates, LLC	4/12/2013	9/30/2028	\$5,237.28	\$5,362.98	NO
300	4,532	Synetic Systems Inc.	8/22/2023	8/31/2029	\$4,532.00	\$4,735.94	TWO, ONE YEAR
500	7,174	Acuity Brands Lighting, Inc	2/7/2012	12/31/2026	\$10,462.08	N/A	YES. VACATING

WHEAT RIDGE OFFICE PARK 4885 Ward Rd, Wheat Ridge, CO

SUITE 100
4,368 RSF

SUITE 500
7,174 RSF

SUITE 300
4,532 RSF

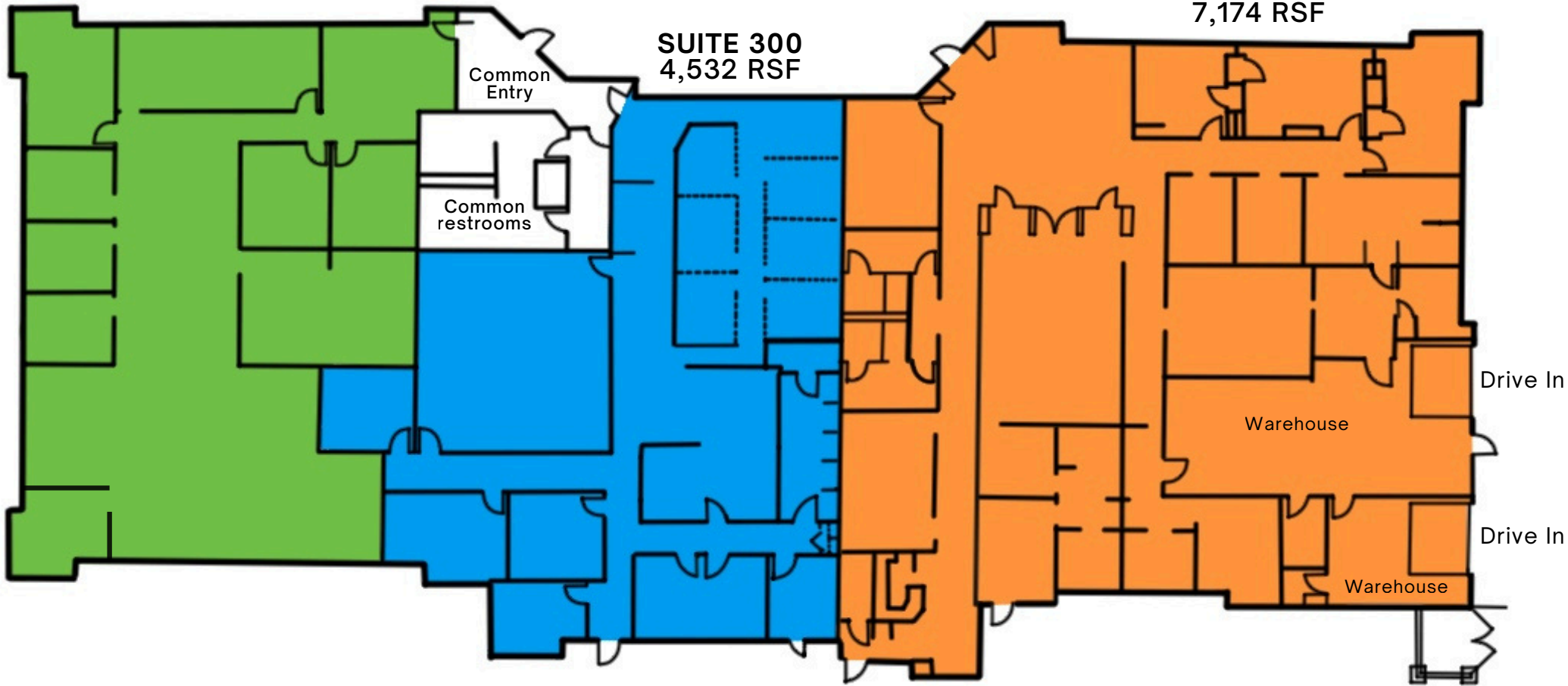

INTERIOR PHOTOS

4885 WARD ROAD
WHEAT RIDGE, CO 80033

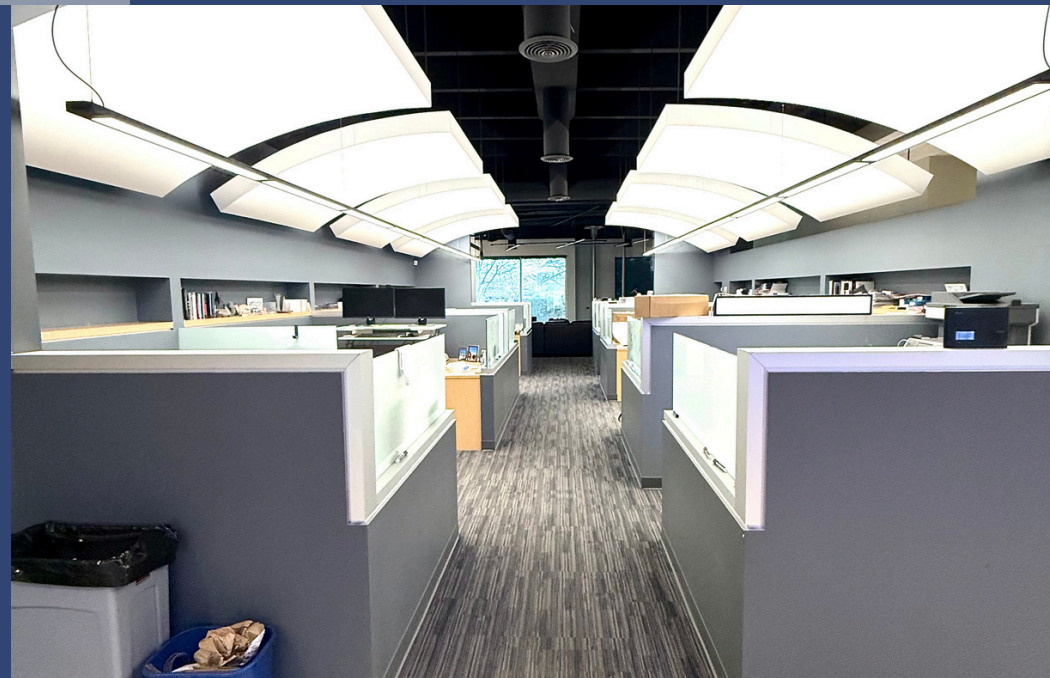

LOCATION MAP

4885 WARD ROAD WHEAT RIDGE, CO 80033

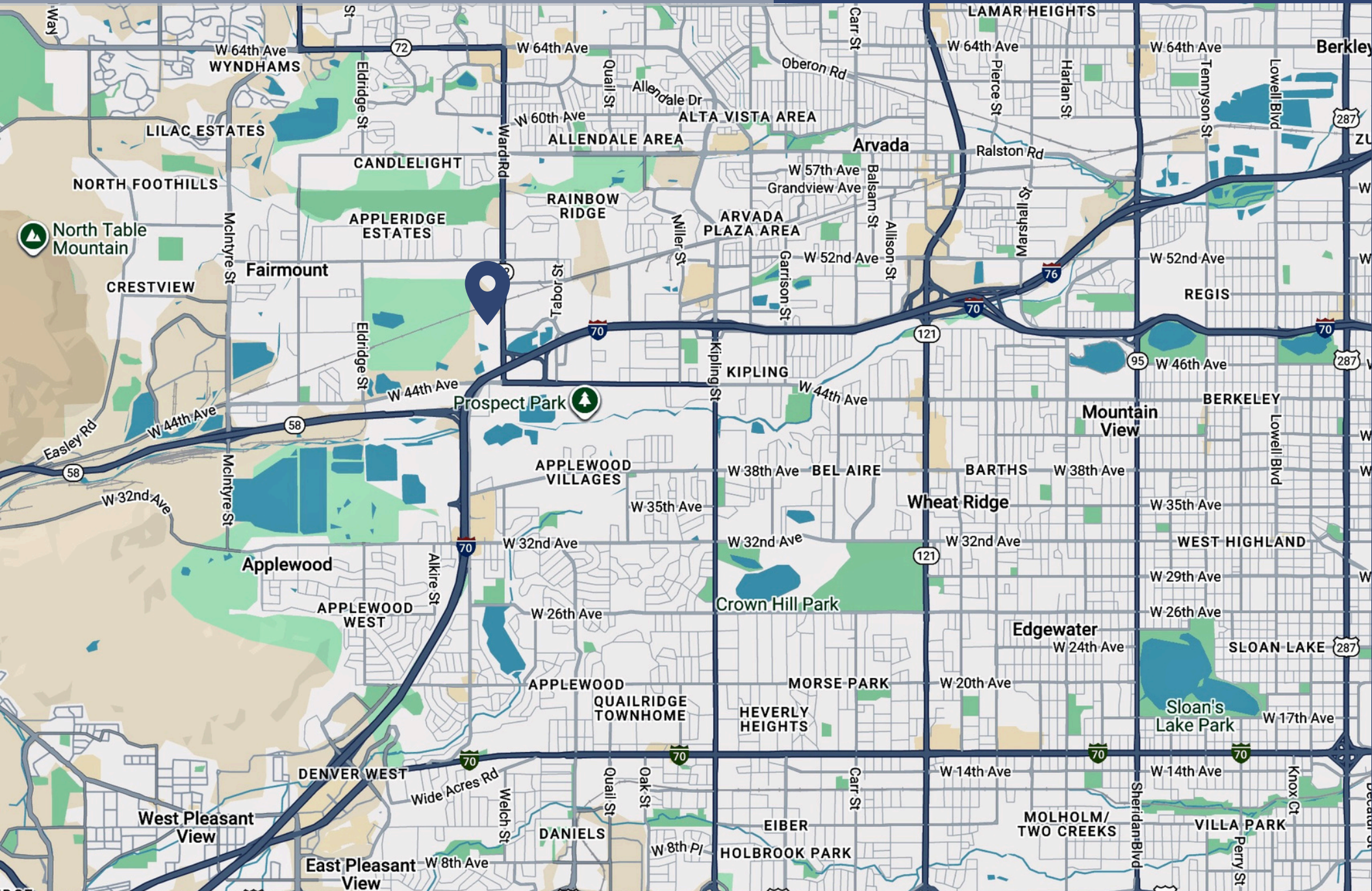

EXCLUSIVELY LISTED BY: DIGBY COMMERCIAL ADVISORS



TANNER DIGBY, SIOR
President

E. Tanner@digbycommercial.com
O. 720.843.1330 ext. 104
C. 720.402.7578



LAUREN MOYER,
Associate Broker

E. Lauren@digbycommercial.com
O. 720.843.1330 ext. 101
C. 720.960.1995